

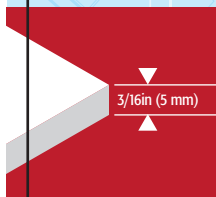





Model WB-6020

FOR USE ON STANDARD FOAMBOARD ONLY  
MUST USE FOAMBOARD UNDERLAYMENT WHILE CUTTING

-  **FOAMBOARD FREESTYLE CUTTER**
-  **CUTTER FREESTYLE POUR PLAQUES DE MOUSSE**
-  **CORTADORA DE ESTILO LIBRE PARA UNICEL ESPUMADO**



-  Contains Foamboard Freestyle Cutter and 2 blades
-  *Contenu Cutter freestyle pour plaques de mousse et 2 lames*
-  Contiene Cortadora de estilo libre para unicel espumado y 2 navajas

www.logangraphic.com



Model WB-6020



Use blade:  
*Utiliser lame:*  
Utilizar navajas:  
WB-5, WB-20

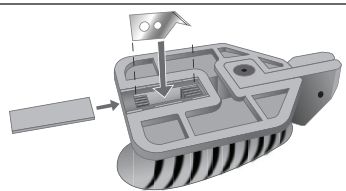

**FOAMBOARD FREESTYLE CUTTER**  
**CUTTER FREESTYLE POUR PLAQUES**  
**DE MOUSSE**  
**CORTADORA DE ESTILO LIBRE PARA**  
**UNICEL ESPUMADO**

NOTE: Use only  
scrap foamboard  
underneath the  
piece being cut.

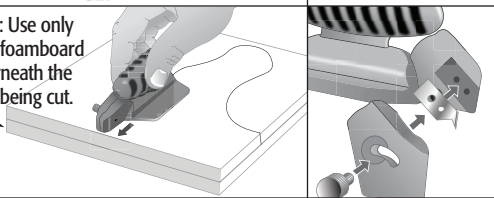

For detailed instructions, go  
to [www.logangraphic.com](http://www.logangraphic.com)  
*Pour des instructions détaillées, visitez le*  
*site [www.logangraphic.com](http://www.logangraphic.com)*  
Para obtener instrucciones detalladas,  
visite [www.logangraphic.com](http://www.logangraphic.com)

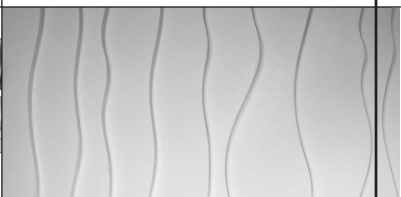
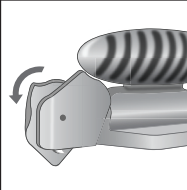

Logan Graphic Products, Inc.  
1100 Brown Street, Wauconda, IL 60084, USA  
1 847 526 5515 • Toll Free 1 800 331 6232  
J1568 REV 2 5-15

**NOT FOR CHILDREN**  
**PAS POUR DES ENFANTS**  
**NO PARA LOS NIÑOS**



**CAUTION: BLADES EXTREMELY SHARP**  
**KEEP OUT OF REACH OF CHILDREN**

Made in USA of Domestic  
and Foreign Components